

DO NOT SCALE FROM THIS DRAWING. USE FIGURED DIMENSIONS IN ALL CASES. VERIFY DIMENSIONS ON SITE AND REPORT ANY DISCREPANCIES TO THE ARCHITECTS IMMEDIATELY. THIS DRAWING IS TO BE READ IN CONJUNCTION WITH THE ARCHITECTS SPECIFICATION. THIS DRAWING IS COPYRIGHT AND MAY ONLY BE REPRODUCED WITH THE ARCHITECTS PERMISSION.

NOTES

WATERROCK - TUSLA COMPLIANCE SUMMARY

| Age Group | 0-1 years | 1-2 years | 2- 6 years |
|--|-------------------|-------------------|--------------------|
| Space required per child (GPA 1996) | 3.7m ² | 2.8m ² | 2.32m ² |
| Staff:Child Ratio (CC Act, 1991, 2016) | 01:03 | 01:05 | 01:06 |
| Max. no. of children per staff | 3 | 5 | 6 |
| Changing (TQRF, 2018) | 1 per 11 children | | |
| Toilet & Washand basin(TQRF, 2018) | 1 per 11 children | | |

| Pre-toddler Room #1 | | | |
|--------------------------|----|--|--|
| No. of Children | 9 | | |
| Staff Requirement | 3 | | |
| Minimum Area requirement | 33 | | |

| Pre-toddler Room #2: | | | |
|--------------------------|--|------|--|
| No. of children | | 12 | |
| Staff Requirement | | 3 | |
| Minimum Area requirement | | 33.6 | |

| Shared facilities:Rm. No's 1,2 | | | |
|--------------------------------|--|---|--|
| Changing | | 2 | |
| Toilet & Washand basin | | 2 | |

| Toddler Room #3, | | | |
|--------------------------|--|--|-------|
| No. of children | | | 17 |
| Staff Requirement | | | 3 |
| Minimum Area requirement | | | 39.44 |

| Toddler Room #4 | | | |
|--------------------------|--|--|-------|
| No. of children | | | 17 |
| Staff Requirement | | | 3 |
| Minimum Area requirement | | | 39.44 |

| Toddler Room #5 | | | |
|--------------------------|--|--|-------|
| No. of children | | | 17 |
| Staff Requirement | | | 3 |
| Minimum Area requirement | | | 39.44 |

| Shared facilities: Rm No.'s 3,4,5 | | | |
|-----------------------------------|--|---|--|
| Changing | | 2 | |
| Toilet & Washand basin | | 4 | |

| Toddler Room #6: Rm. No. 6 | | | |
|----------------------------|--|--|-------|
| No. of children | | | 17 |
| Staff Requirement | | | 3 |
| Minimum Area requirement | | | 39.44 |

| Shared facilities: Rm No. 6 | | | |
|-----------------------------|--|---|--|
| Changing | | 1 | |
| Toilet & Washand basin | | 1 | |

TÚSLA, Early Years Inspectorate, Quality and Regulatory Framework - Sessional Pre-School Service, 2018 (TÚSLA,2018)
 CHILD CARE ACT 1991 (EARLY YEARS SERVICES) REGULATIONS 2016
 Childcare Facility Guidelines for Planning Authorities, 2001 (CFGPA,2001)
 Safety, Health and Welfare at Work Act, 2005
 Cork County Development Plan, 2022-2028 (CCDP,2022)

| REV | DATE | DRN | NOTES |
|-----|------|-----|-------|
| | | | |
| | | | |
| | | | |

PLANNING

Gittens Murray Architects Ltd

JOB
 WATERROCK HOUSING,
 MIDDLETON, CO. CORK

CLIENT
 HAVEN FALLS LTD.

TITLE
 PROPOSED NEIGHBOURHOOD CENTRE
 CRECHE & COMMERCIAL
 GROUND FLOOR PLAN

DATE 07.10.2022 SCALE 1:100 @ A1, 1:200@A3
 DRN SH CHECKED MG

GMA
 ARCHITECTS
 INTERIOR DESIGNERS
 5 William St.
 Kilkenny.

TEL: (0 5 6) 77 53933
 FAX: (0 5 6) 77 53909
 email: info@gmarch.net

JOB NUMBER DRWG NUMBER REVISION
20/033-LRD-A-NC-100

TOWN CENTRE - COMMERCIAL

- NOTES:
- FOR INDIVIDUAL UNIT FLOOR LEVELS PLEASE REFER TO ENGINEERING SITE LAYOUT
 - FOR INDIVIDUAL UNIT NORTH POINT ORIENTATION PLEASE REFER TO SITE LAYOUT MAP
 - APPLIED BRICK FINISH IS DEPENDENT ON AVAILABILITY AND SITE LOCATION
 - ALL DIMENSIONS ARE IN mm
 - PLANNING DRAWING ONLY
 - DO NOT SCALE FROM DRAWINGS

DETAIL NUMBER LOCATION DETAIL SHEET
 DETAIL NAME DETAIL SCALE

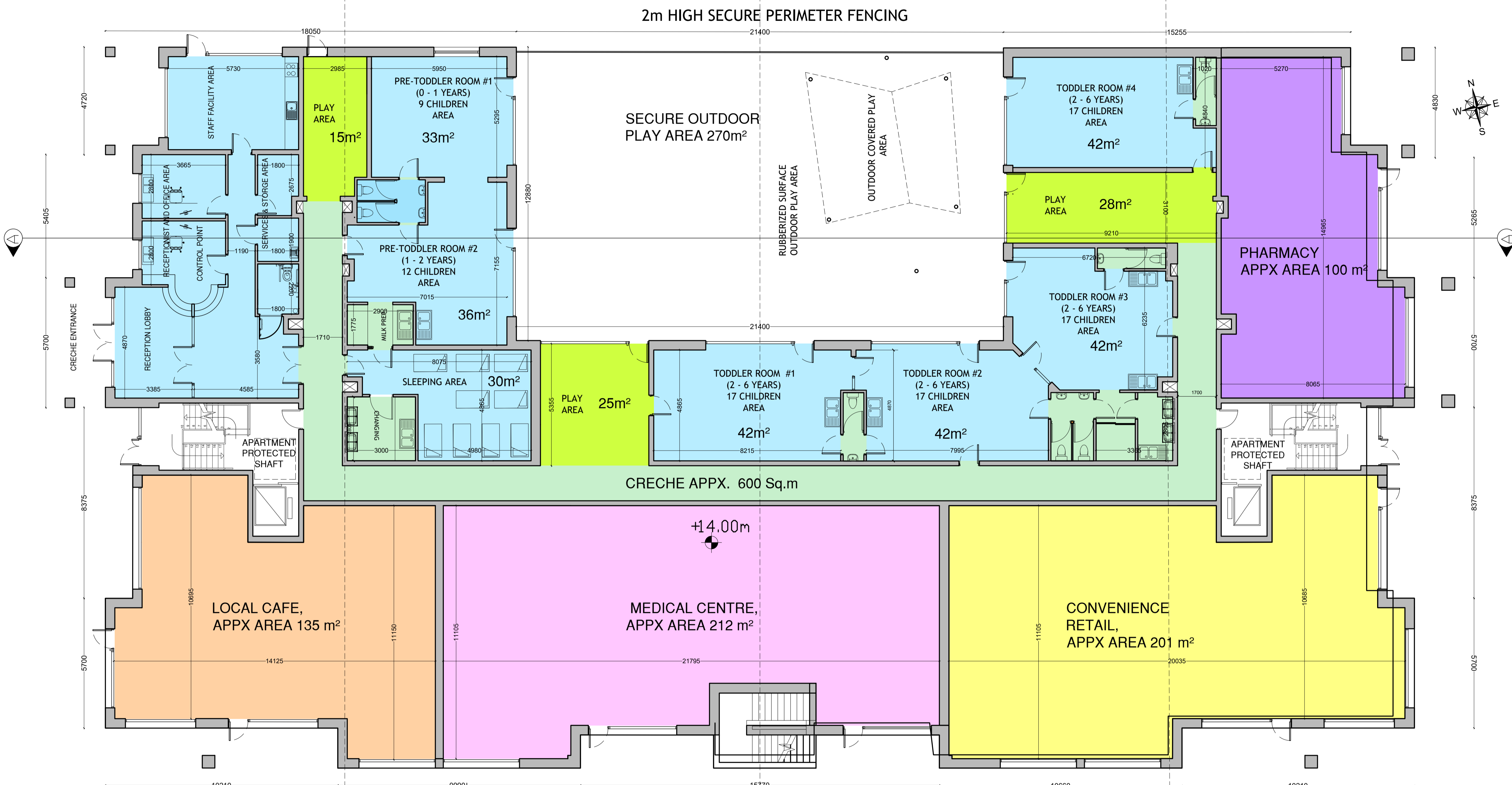

2m HIGH SECURE PERIMETER FENCING

SECURE OUTDOOR PLAY AREA 270m²

CRECHE APPX. 600 Sq.m

LOCAL CAFE, APPX AREA 135 m²

MEDICAL CENTRE, APPX AREA 212 m²

CONVENIENCE RETAIL, APPX AREA 201 m²

RETAIL APPX. AREA:
 648 Sq.m
 + 28 Sq.m service Space
 =676 Sa.m

'NEIGHBOURHOOD CENTRE'
 FLOORPLAN +0,
 SCALE 1:200 @A3, 1:100@A1